

COLAISDE NA GAIDHLIG

The Gaelic College



Colaisde na Gàidhlig, founded in 1938, is first and foremost an educational non-profit institution, offering year-round programming in the culture, music, language, crafts, customs, and traditions of the immigrants from the Highlands of Scotland. The only institution of its kind in North America, students of all ages and skill levels visit the College every year to study under some of the finest instructors in Nova Scotia Gaelic culture.

College Room Total: **46 Guest Rooms** // Single Occupancy: **46** // Double Occupancy: **96** // Dorm Style: **124**

MacKenzie Hall



MacKenzie Hall: includes guest rooms, cafeteria, upstairs lounge, meeting space

Meeting area: 1st floor: 59ft x 21ft [Seating concert style: 100 // Meeting: 60 with 1/2 rounds]

Cafeteria: 1st floor: 45ft x 21ft [Seating banquet style using both sides: 180 // Cafeteria side only: 70]

Fireplace area: 25ft x 21ft

Room Total: 18 rooms *no elevator*

1st floor: 7 guest rooms [Queen bed + Full bath + Room with 2 sets of bunk beds]

2nd floor: 8 guest rooms [Queen bed + Full bath + Room with 2 sets of bunk beds]

3 guest rooms - loft area [Queen bed + full bath]





MacLeod & Highland House

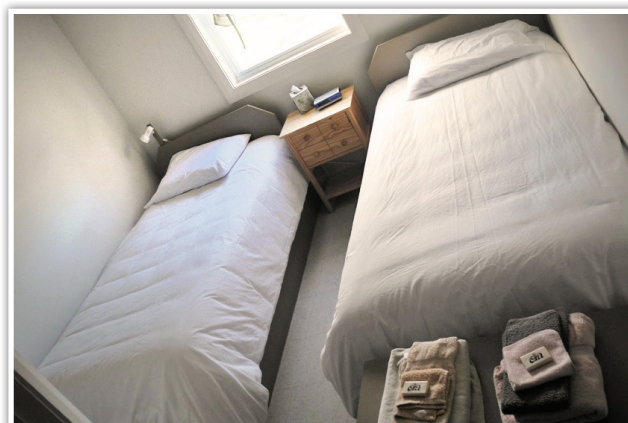

MacLeod House: includes guest rooms, kitchenette, small meeting or lounge area

Meeting area: 1st floor: 26ft x 26ft [seating concert style: 30 // meeting: 20]

Room Total: 14 Rooms *no elevator*

1st floor: 5 guest rooms [double bed + full bath]

2nd floor: 9 guest rooms [2 single beds + full bath]

Highland House: includes guest rooms, kitchenette, small meeting or lounge area

Meeting area: 1st floor: 26ft x 26ft [seating concert style: 30 // meeting: 20]

Room Total: 14 Rooms *no elevator*

1st floor: 4 guest rooms [double bed + full bath]

1 guest room [2 single beds + 1/2 bath (toilet & sink)]

2nd floor: 5 guest rooms [2 single beds + 1/2 bath (toilet & sink)]

3 guest rooms [2 single beds + full bath]

1 guest room [double bed + full bath]





Great Hall of the Clans



Museum: includes small theater room or bar area, green room, main floor
Main floor: 86ft x 32ft | excluding stage 73ft x 32ft // floor to ceiling: 18ft
[concert or theater style: 263]
[wedding: 180 with full rounds - 8/table]
[conference: 150 with 1/2 rounds - 6/table]

Outdoor Performance Centre

Outdoor Performance Centre: includes stage, canteen, bar area, bench seating
Bench seating: 350
Bench seating, standing room or bring your own chair: 2000

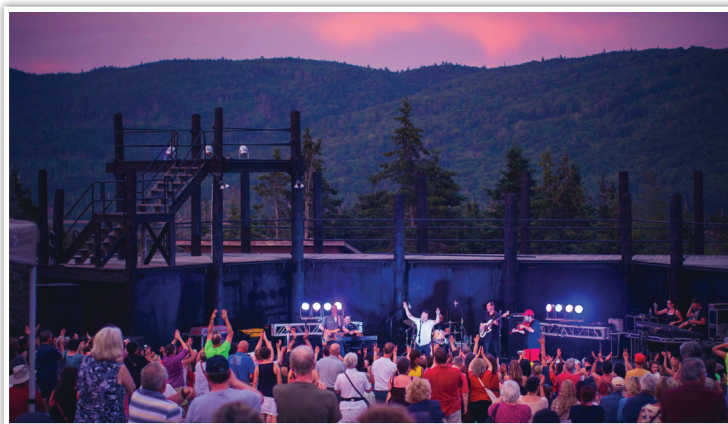

MacKenzie Hall

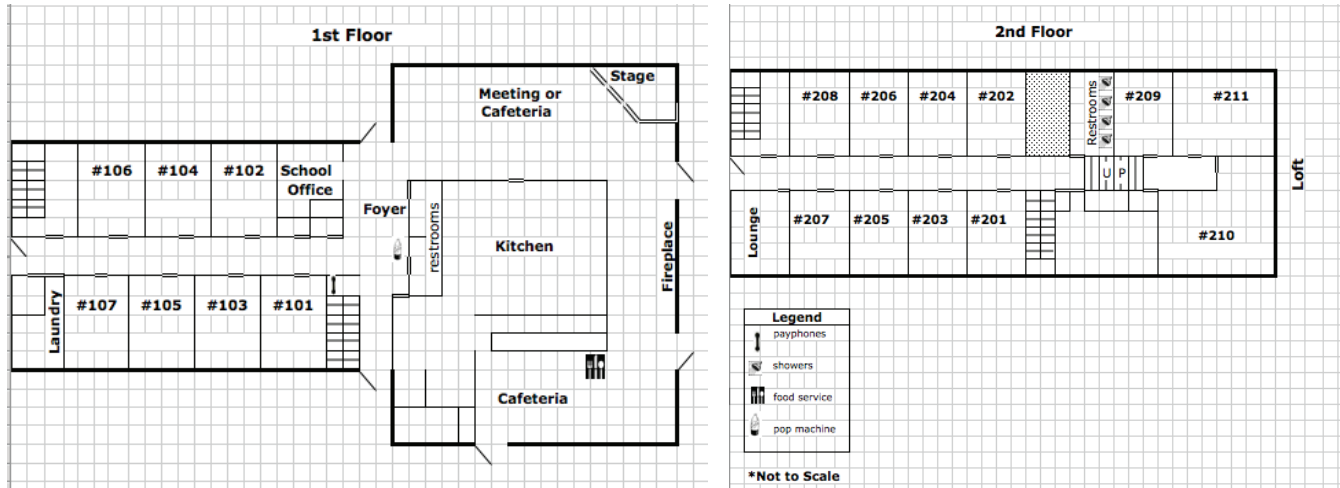

MacLeod & Highland House

